

Grey Acetal Tube To Hose Elbow (Imperial)

Converts a john guest pushfit connection, to a barbed hose connection.

Overview

John Guest grey push-fit acetal tube to tube hose stem elbow fitting converts a John Guest push-fit connection to a 90° hose type threaded connection. Fast and simple to install, John Guest push-fit fittings create an instant push-fit connection and leak tight seal without the need for tools, hot works or sealing agents.

The unique collet locking design firmly and securely holds the pipe in place without deforming the pipe or restricting flow. Fittings are corrosion resistant and fully demountable, improving system performance and reducing system downtime during maintenance.

Manufactured in grey push-fit acetal copolymer, the fitting is suitable for foodstuff, potable liquids and inert gases. In accordance with the British Beer & Pub Association Code of Practice, fittings can also be used with N2/CO2 and mixed gas dispense lines, as well as air, pneumatic and vacuum applications. All John Guest fittings are manufactured and assembled in the UK.



Features & Benefits

- Strong acetal copolymer fitting with nitrile O-Ring
- Airtight connection with superior flow characteristics
- Instant push-fit connection and demountable without tools
- Secure collet cover prevents accidental disconnection
- Suitable for air and pneumatics piping systems up to 10 bar
- Ideal for air, inert gases and vacuum applications
- Food grade fitting suitable for potable liquids
- Compatible with soft metal or plastic pipe/tubing

Product code	Description	Size	Bag QTY
PI290808S	Tube To Hose Elbow	1/4" x 1/4"	10
PI290810S	Tube To Hose Elbow	1/4" x 5/16"	10
PI291008S	Tube To Hose Elbow	5/16" x 1/4"	10
PM290808S	Tube To Hose Elbow	5/16" x 5/16"	10
PI291208S	Tube To Hose Elbow	3/8" x 1/4"	10
PI291210S	Tube To Hose Elbow	3/8" x 5/16"	10



Grey Acetal Tube To Hose Elbow (Imperial)

Application	Maximum working pressure, bar
Air	16 Bar

Materials	Application
Body	Acetal Copolymer (Unfilled),
	Potable Liquid
	Food Grade Liquid
	Inert Gases
	Vacuum

Dimensions – All measurements in mm unless otherwise stated

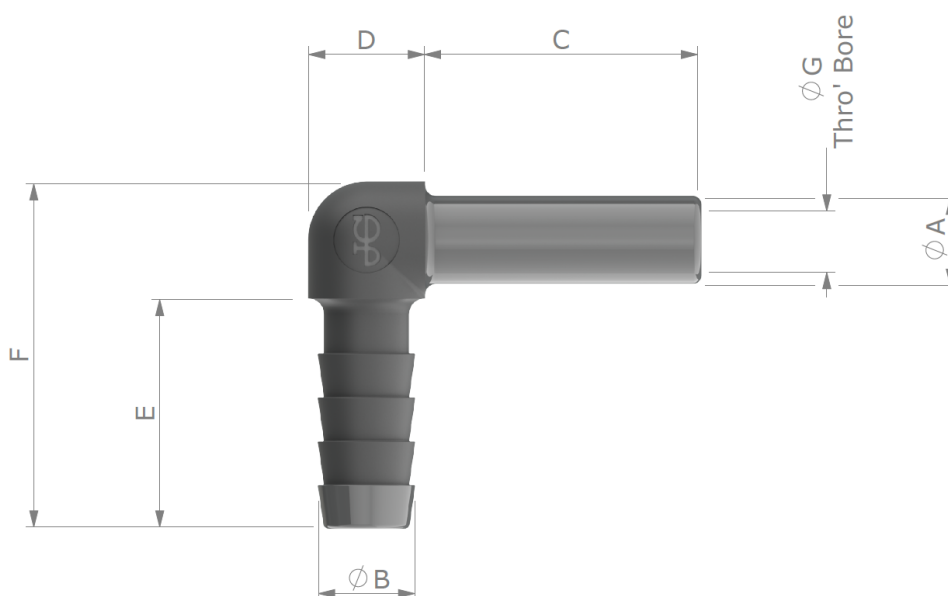

Product No.	Stem O/D - Hose I/D	A	B	C	D	E	F	G
PI290808S	1/4" - 1/4"	1/4" [6.3]	0.270 [6.9]	0.94 [24.0]	0.34 [8.6]	0.82 [20.8]	1.16 [29.4]	0.14 [3.5]
PI290810S	1/4" - 5/16"	1/4" [6.3]	0.346 [8.8]	0.94 [24.0]	0.42 [10.6]	0.82 [20.8]	1.24 [31.4]	0.18 [4.5]
PI291008S	5/16" - 1/4"	5/16" [7.94]	0.270 [6.9]	0.98 [25.0]	0.34 [8.6]	0.82 [20.8]	1.16 [29.4]	0.14 [3.5]
PM290808S	5/16" - 5/16"	5/16" [7.94]	0.346 [8.8]	0.98 [25.0]	0.42 [10.6]	0.82 [20.8]	1.24 [31.4]	0.22 [5.5]
PI291208S	3/8" - 1/4"	3/8" [9.53]	0.270 [6.9]	1.10 [28.0]	0.34 [8.6]	0.82 [20.8]	1.16 [29.4]	0.14 [3.5]
PI291210S	3/8" - 5/16"	3/8" [9.53]	0.346 [8.8]	1.10 [28.0]	0.42 [10.6]	0.82 [20.8]	1.24 [31.4]	0.22 [5.5]

Dimensions in Inches & [mm]